

PRIORY GRANGE NURSING HOME - RHOS-ON-SEA

NOTES
ALL WORK TO BE CARRIED OUT IN ACCORDANCE WITH THE BUILDING REGULATIONS AND THE REQUIREMENTS OF THE LOCAL AUTHORITY.

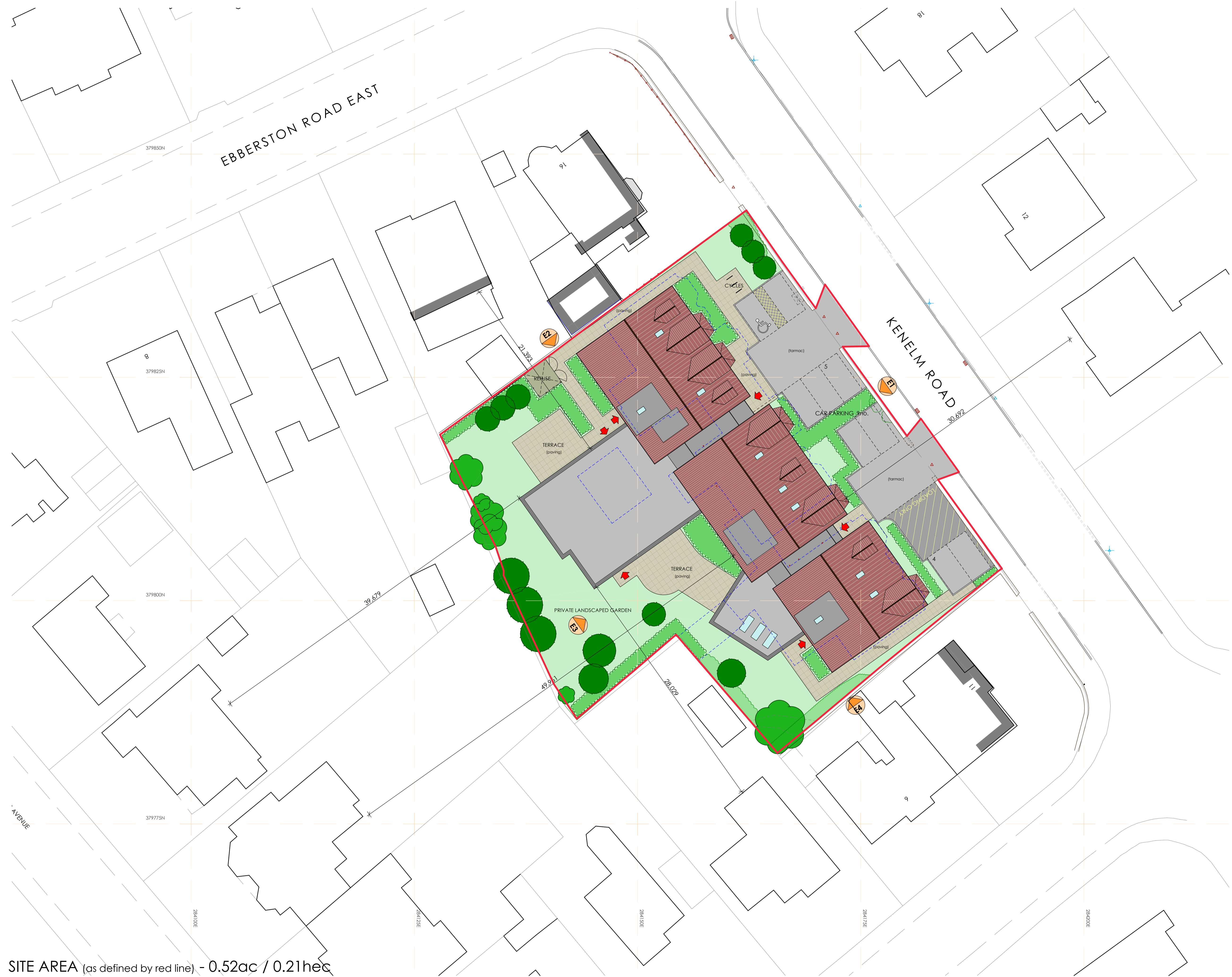
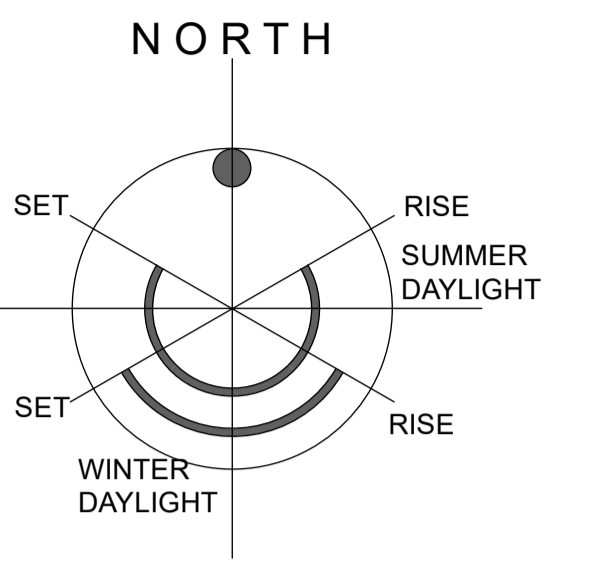
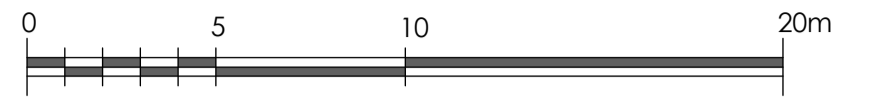

SITE AREA (as defined by red line) - 0.52ac / 0.21hec

PD1	SITE DIMENSIONS ADDED, MINOR MODIFICATIONS.	IR	19/06/24
REV	DESCRIPTION	BY	CHKD DATE

LOROC
ARCHITECTS

5TH FLOOR, 15 ST. PAUL'S STREET, LEEDS, LS1 2JG
T: 0113 233 7755
W: WWW.LOROC.CO.UK

3RD FLOOR, 86 - 90 PAUL STREET, LONDON, EC2A 4NE
T: 0203 875 5333

PROJECT: PRIORY GRANGE NURSING HOME
RHOS-ON-SEA

TITLE: GENERAL ARRANGEMENT
PLANNING
PROPOSED SITE PLAN

DRAWING NO.	1710-ARC-22-XX-OR-A_1002	REVISION	PD1
SCALE	1:200 @ A1	DATE	JULY 2024
DRAWN BY	IR	CHECKED BY	

PURPOSE OF ISSUE

<input checked="" type="radio"/> PLANNING	<input type="radio"/> BUILDING REGS	<input type="radio"/> TENDER
<input type="radio"/> COMMENT	<input type="radio"/> INFORMATION	<input type="radio"/> CONSTRUCTION

THIS DRAWING IS COPYRIGHT AND THE INTELLECTUAL PROPERTY OF LOROC ARCHITECTS LIMITED. THIS DRAWING MAY NOT BE REPRODUCED IN WHOLE OR IN PART WITHOUT WRITTEN AUTHORITY. NO DIMENSIONS TO BE SCALED FROM THIS DRAWING. ALL DIMENSIONS TO BE CHECKED ON SITE PRIOR TO COMMENCEMENT OF WORKS AND ANY DISCREPANCIES REPORTED TO THE ARCHITECT/ENGINEER/CONTRACTOR.

